

KARS İLİ AKYAKA İLÇESİ BOYUNTAŞ KÖYÜ  
111 ADA 30 PARSEL ile 158 ADA 1 PARSELDEKİ TESCİLLİ MEZARLIKLAR ve KORUMA ALANI

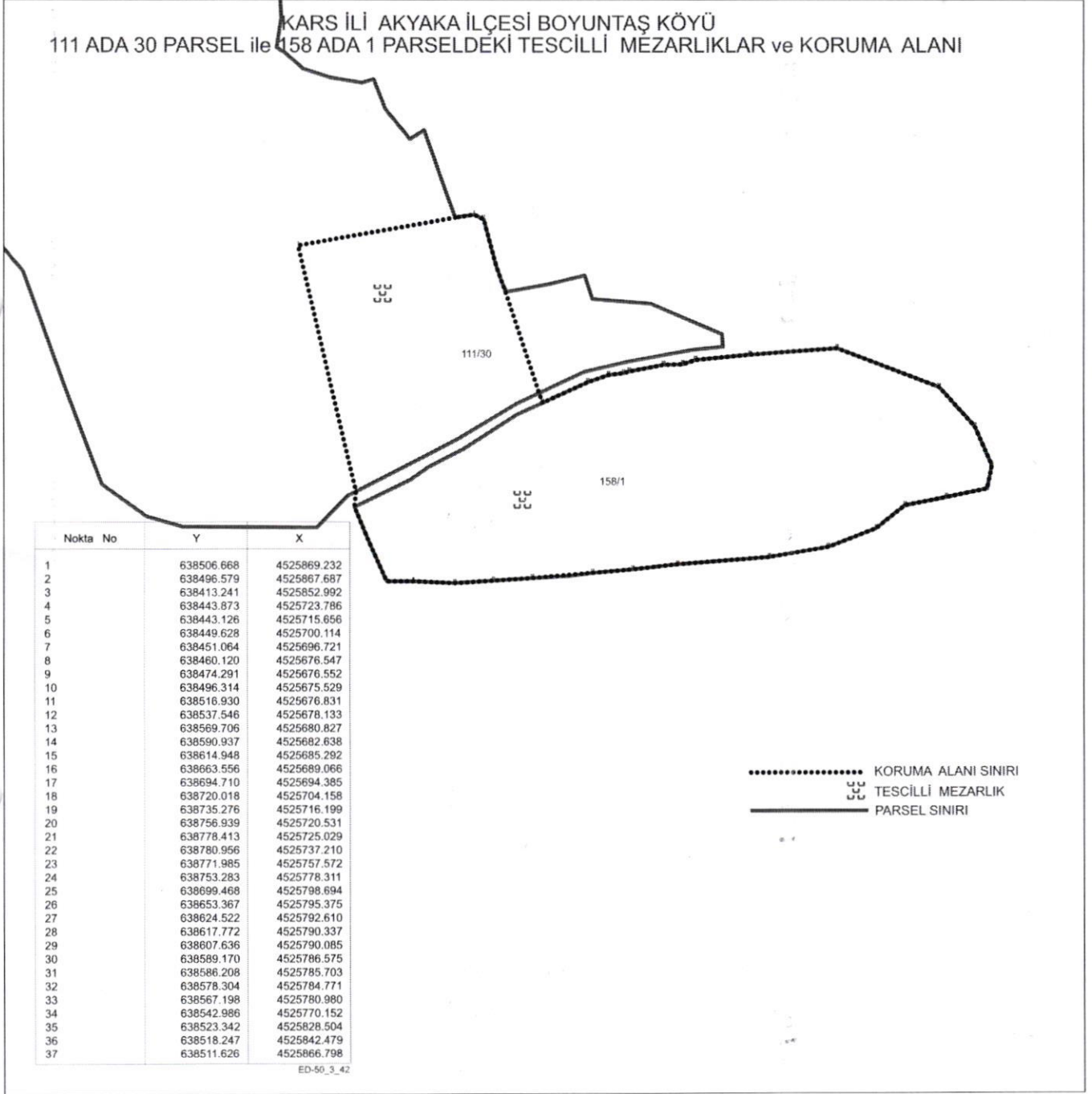

Nokta No	Y	X
1	638506.668	4525869.232
2	638496.579	4525867.687
3	638413.241	4525852.992
4	638443.873	4525723.786
5	638443.126	4525715.656
6	638449.628	4525700.114
7	638451.064	4525696.721
8	638460.120	4525676.547
9	638474.291	4525676.552
10	638496.314	4525675.529
11	638516.930	4525676.831
12	638537.546	4525678.133
13	638569.706	4525680.827
14	638590.937	4525682.638
15	638614.948	4525685.292
16	638663.556	4525689.066
17	638694.710	4525694.385
18	638720.018	4525704.158
19	638735.276	4525716.199
20	638756.939	4525720.531
21	638778.413	4525725.029
22	638780.956	4525737.210
23	638771.985	4525757.572
24	638753.283	4525778.311
25	638699.468	4525798.694
26	638653.367	4525795.375
27	638624.522	4525792.610
28	638617.772	4525790.337
29	638607.636	4525790.085
30	638589.170	4525786.575
31	638586.208	4525785.703
32	638578.304	4525784.771
33	638567.198	4525780.980
34	638542.986	4525770.152
35	638523.342	4525828.504
36	638518.247	4525842.479
37	638511.626	4525866.798

ED-50\_3\_42

KARS K.V.K.B.K.'nın 24.08.2022  
Tarih ve 3614 sayılı karar ekidir.



Gökhan CAN  
Harita Mühendisi