

KARŞI KÜLTÜR VARLIKLARINI KORUMA BÖLGE KURULUMU
KARŞI KÜLTÜR VARLIKLARINI KORUMA BÖLGE KURULUMU
KARŞI KÜLTÜR VARLIKLARINI KORUMA BÖLGE KURULUMU

İĞDIR İLİ TUZLUCA İLÇESİ ORTA MAHALLESİ
107 ADA 13 PARSELDEKİ TESCİLLİ KIRMIZI RENKLİ TAŞ BİNA ve KORUMA ALANI

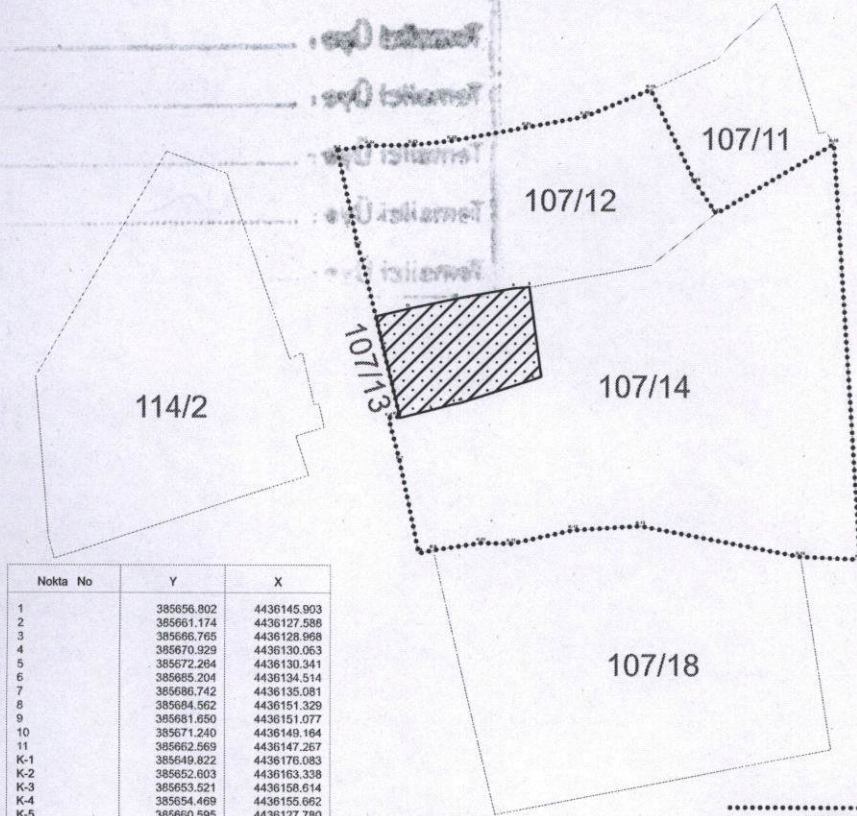

| Nokta No | Y | X |
|----------|------------|-------------|
| 1 | 385656.802 | 4436145.903 |
| 2 | 385661.174 | 4436127.588 |
| 3 | 385666.765 | 4436128.968 |
| 4 | 385670.929 | 4436130.063 |
| 5 | 385672.264 | 4436130.341 |
| 6 | 385685.204 | 4436134.514 |
| 7 | 385686.742 | 4436135.081 |
| 8 | 385684.562 | 4436151.329 |
| 9 | 385681.650 | 4436151.077 |
| 10 | 385671.240 | 4436149.184 |
| 11 | 385662.569 | 4436147.267 |
| K-1 | 385649.822 | 4436176.083 |
| K-2 | 385652.603 | 4436163.338 |
| K-3 | 385653.521 | 4436158.614 |
| K-4 | 385654.469 | 4436155.662 |
| K-5 | 385660.595 | 4436127.780 |
| K-6 | 385659.175 | 4436127.510 |
| K-7 | 385661.193 | 4436119.696 |
| K-8 | 385664.680 | 4436102.971 |
| K-9 | 385667.295 | 4436103.554 |
| K-10 | 385675.903 | 4436104.869 |
| K-11 | 385681.392 | 4436104.750 |
| K-12 | 385682.578 | 4436107.223 |
| K-13 | 385704.792 | 4436107.995 |
| K-14 | 385733.801 | 4436102.539 |
| K-15 | 385744.642 | 4436102.082 |
| K-16 | 385739.621 | 4436177.552 |
| K-17 | 385716.416 | 4436164.752 |
| K-18 | 385714.638 | 4436170.314 |
| K-19 | 385706.493 | 4436187.270 |
| K-20 | 385694.586 | 4436182.394 |
| K-21 | 385684.002 | 4436180.393 |
| K-22 | 385670.474 | 4436177.894 |
| K-23 | 385663.474 | 4436177.095 |
| K-24 | 385655.672 | 4436176.944 |

..... KORUMA ALANI SINIRI
TESCİLLİ KIRMIZI RENKLİ TAŞ BİNA ve PARSELI
PARSEL SINIRI

ED-60_3_45

KARS K.V.K.B.K.'nun 25.05.2023

Tarih ve 28/11 sayılı karar ekidir.



Gökhan CAN
Harit. Mühendisi